

# versatile™ 4C Surface Mount Collar, SM14D

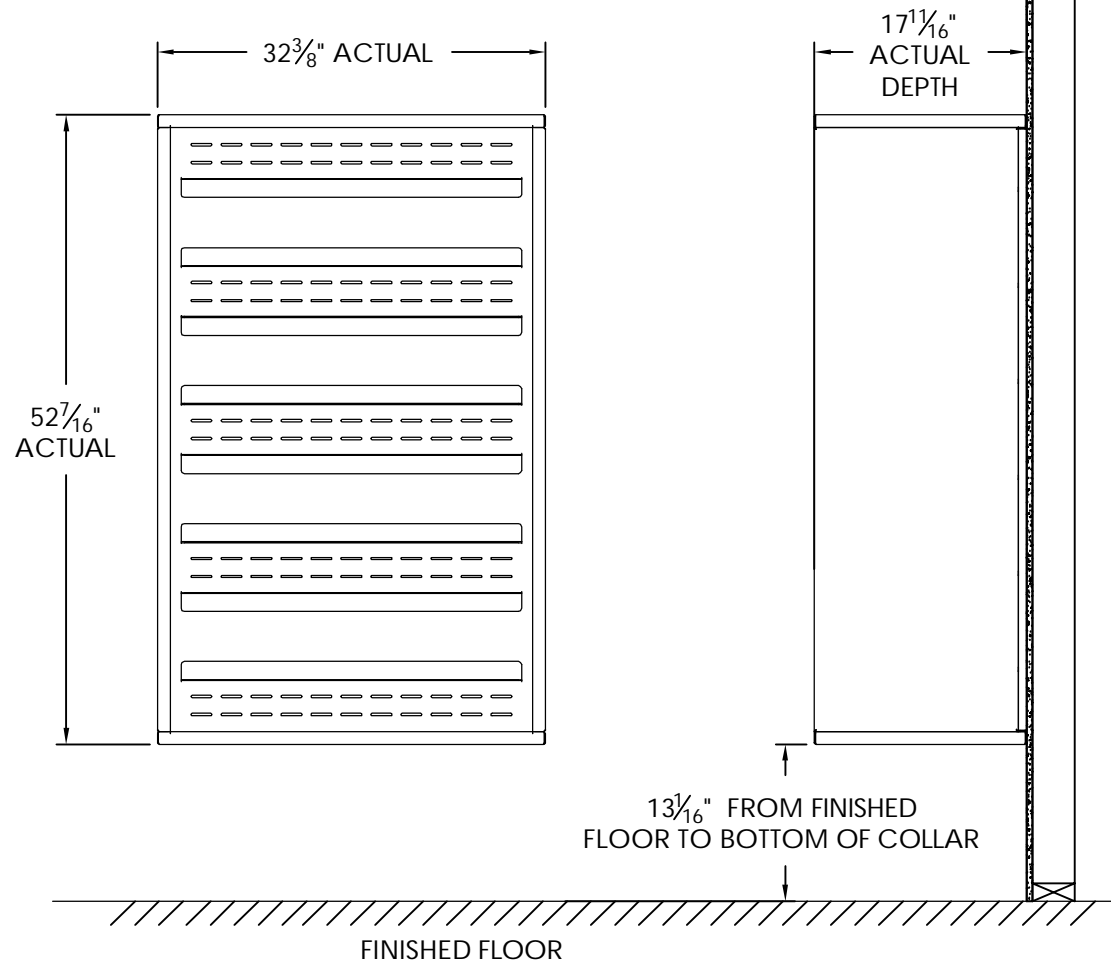

## Notes:

1. Designed to mount Florence Versatile™ 4C mailbox double column 14-High Suite modules (sold separately).
2. For use with front loading modules only.

PRODUCT SERIES: VERSATILE™ 4C SURFACE MOUNT COLLAR

**AF FLORENCE**  
manufacturing company

5935 Corporate Drive • Manhattan, KS 66503  
www.florencemailboxes.com • (800) 275-1747

A GIBRALTAR INDUSTRIES COMPANY

|                |         |               |            |
|----------------|---------|---------------|------------|
| MODEL          | SM14D   | REV           | B          |
| SCALE          | NONE    | LAST REV DATE | 07/02/2014 |
| DRAWING NUMBER | SM14DCS | DRAWN BY      | TNS        |

versatile™ 4C Mailbox, 4C14D-14

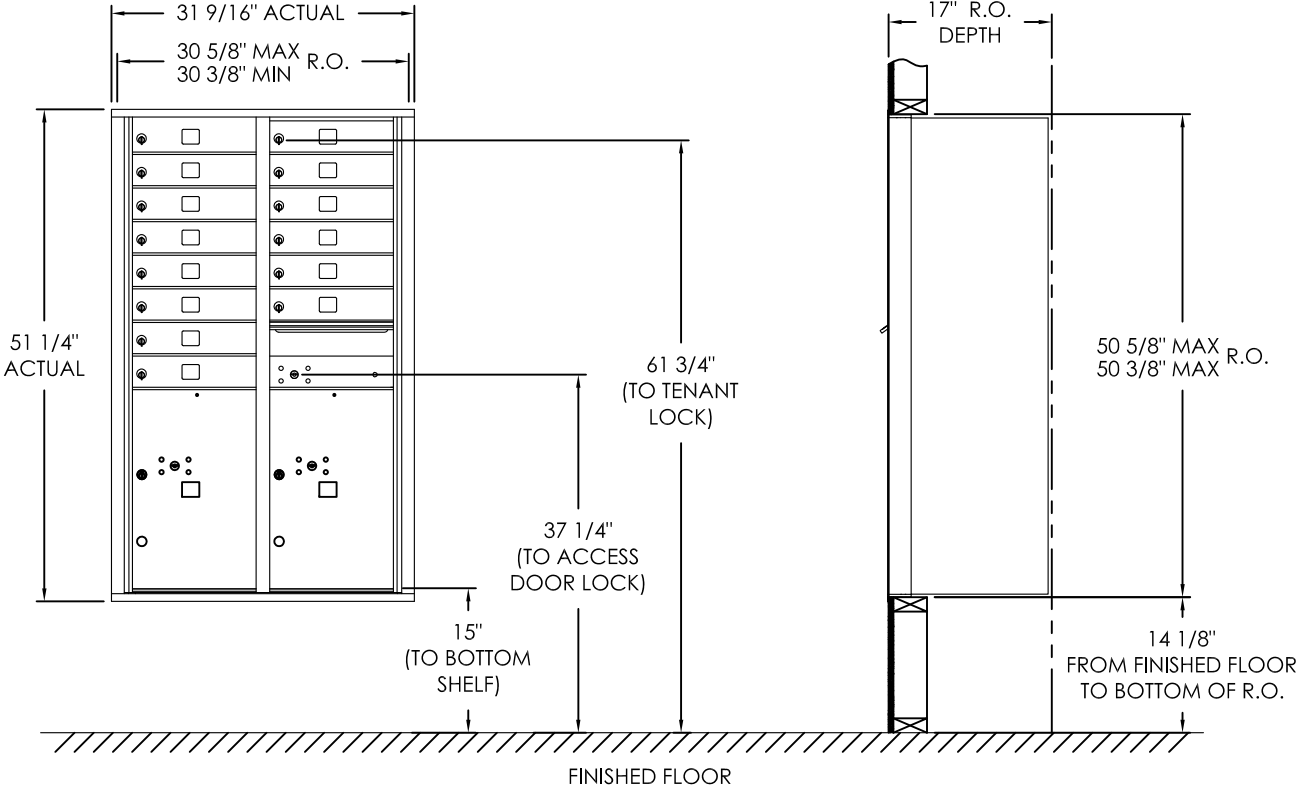

COMPARTMENT CHART

| DESCRIPTION   | COMPARTMENT | COMPARTMENT SIZE          | QTY. |
|---------------|-------------|---------------------------|------|
| MAILBOX       | MB1         | 3" H x 12" W x 15" D      | 14   |
| OUTGOING MAIL | OM2         | 6-1/2" H x 12" W x 15" D  | 1    |
| PARCEL        | PL6         | 20-1/2" H x 12" W x 15" D | 2    |

Notes:

- This module meets the USPS STD-4C requirements for installation defined below when the mailbox is installed per the dimensions provided on this drawing.
  - At least one customer compartment shall be positioned less than 48" above finished floor (AFF).
  - No parcel locker (interior bottom shelf) shall be positioned less than 15" AFF.
  - No patron (tenant) lock shall be positioned more than 67" AFF.
  - No customer compartment (interior bottom shelf) shall be positioned less than 28" AFF.
  - The USPS Arrow lock shall be positioned 36"- 48" AFF.
- This 4C mailbox can also be used for private applications.
- The rough opening width for multi-unit 4C installations is provided using the Florence configurator: [www.florencemailboxes.com/configurator](http://www.florencemailboxes.com/configurator).

PRODUCT SERIES: VERSATILE™ 4C FRONT LOAD MAILBOX

**FLORENCE**  
**CORPORATION**

5935 Corporate Drive • Manhattan, KS 66503  
800.275.1747 • [www.florencemailboxes.com](http://www.florencemailboxes.com)

|                           |                        |
|---------------------------|------------------------|
| MODEL 4C14D-14            | REV B                  |
| SCALE NONE                | LAST REV DATE 07/08/19 |
| DRAWING NUMBER 4C14D-14CS | DRAWN BY RAK           |